

Area of Application:
Bench mounted
Water

Max. working pressure 10 bar
Min. temperature 5°C
Max. temperature 90°C

Details:
Ceramic headwork open/close 90°
3-Zone colour, acc. to EN13792:2002
Fixed
1/2" removable nozzle

Materials in media contact:
Brass
Rubber, EPDM
Silicone based lubricant
Ceramic

Mounting:
M30x1,5 nut with locking pins o-ring and washer (See 94G0232)

Inlet / outlet connection:
DN8 hose with G3/8 female inlet
DIN 12 898, form A, size 1, 1/2" hose nozzle

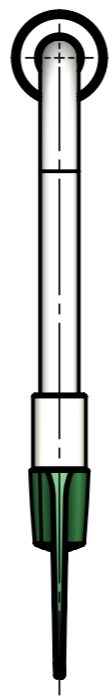
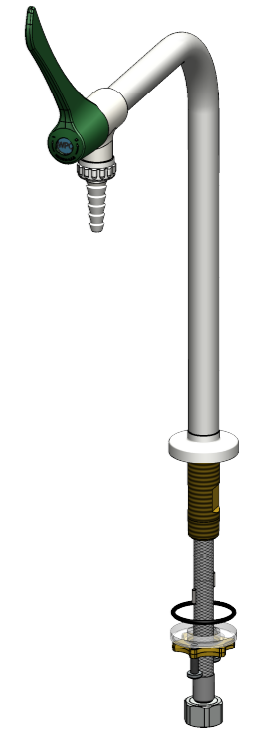
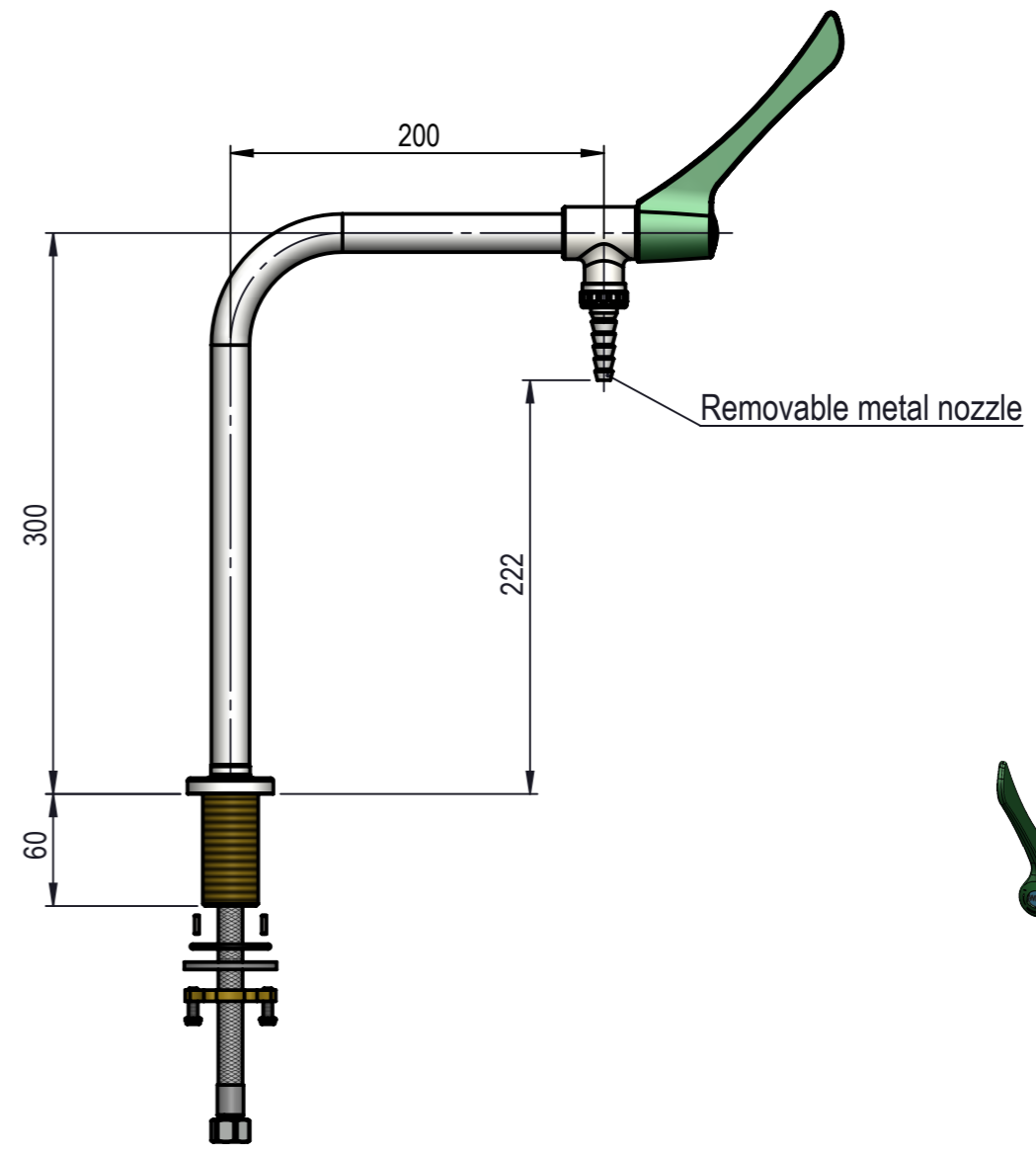
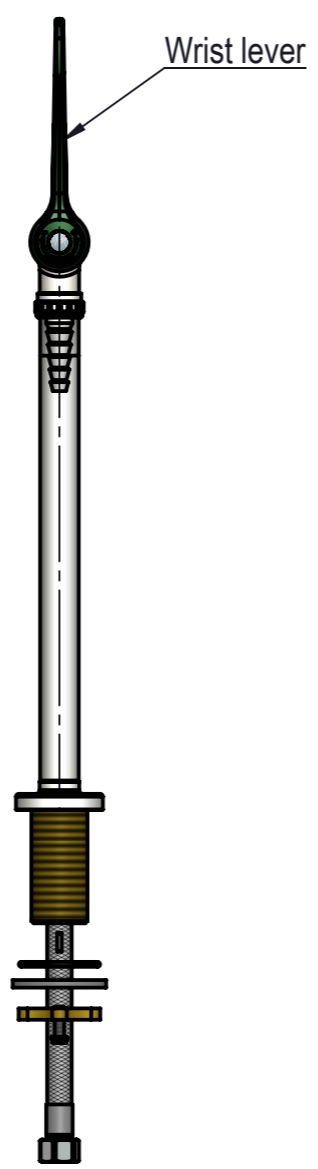

MEDIA CODE XX FOR WATER
ONE MEDIA FITTING
ACCORDING TO EN 13792

Media	Media description	Media code XX
WPC	Water potable cold	01
WPH	Water potable hot	02
WNC	Water non-potable, cold	07
WNH	Water non-potable, hot	08

Description: 1-Valve, Bench mounted, 1-Hole, Rem. Nozzle, DN8 hose with G3/8 female inlet							Media: Water			
							Comments: 2533master020			
							Drawing type: Customer drawing			
							Weight: 1.497 Kg			
B	09-01-18			MWA			Designed by: TLA	Drawn by: TLA	Released on TM No.	Date: 05-12-2018
Rev.	Pos.	Date	TM No.	Design by	Drawn by:	Change:	This drawing is our property and cannot be given to a third party, copied or otherwise used without our permission. BROEN-LAB A/S.			
							Format: A3		Drawing No.: 253333510XX-52D	

BROEN-LAB