

Spare parts for Broen-Lab Portable Eyewasher

Part	Sparepart number	Description
1		Eye shower unit for ESS
2	1760205	Complete Extender
3		Complete Pusharm
4	17528279	Ballofix valve for ESS, short
5	1760206	Complete Body
6	1731178G	Complete Clamp incl. sealing
7	1731163	Bracket for Hand-held eye shower
8	27100031000001	Hand-held eye shower
9		Complete Vessel
10	94H40561200	Hose for Hand-held eye shower 1,2 m
11	1731174G	Pipe
12	1731179G	Dolly
13	G753002	Aquasep 236 ml

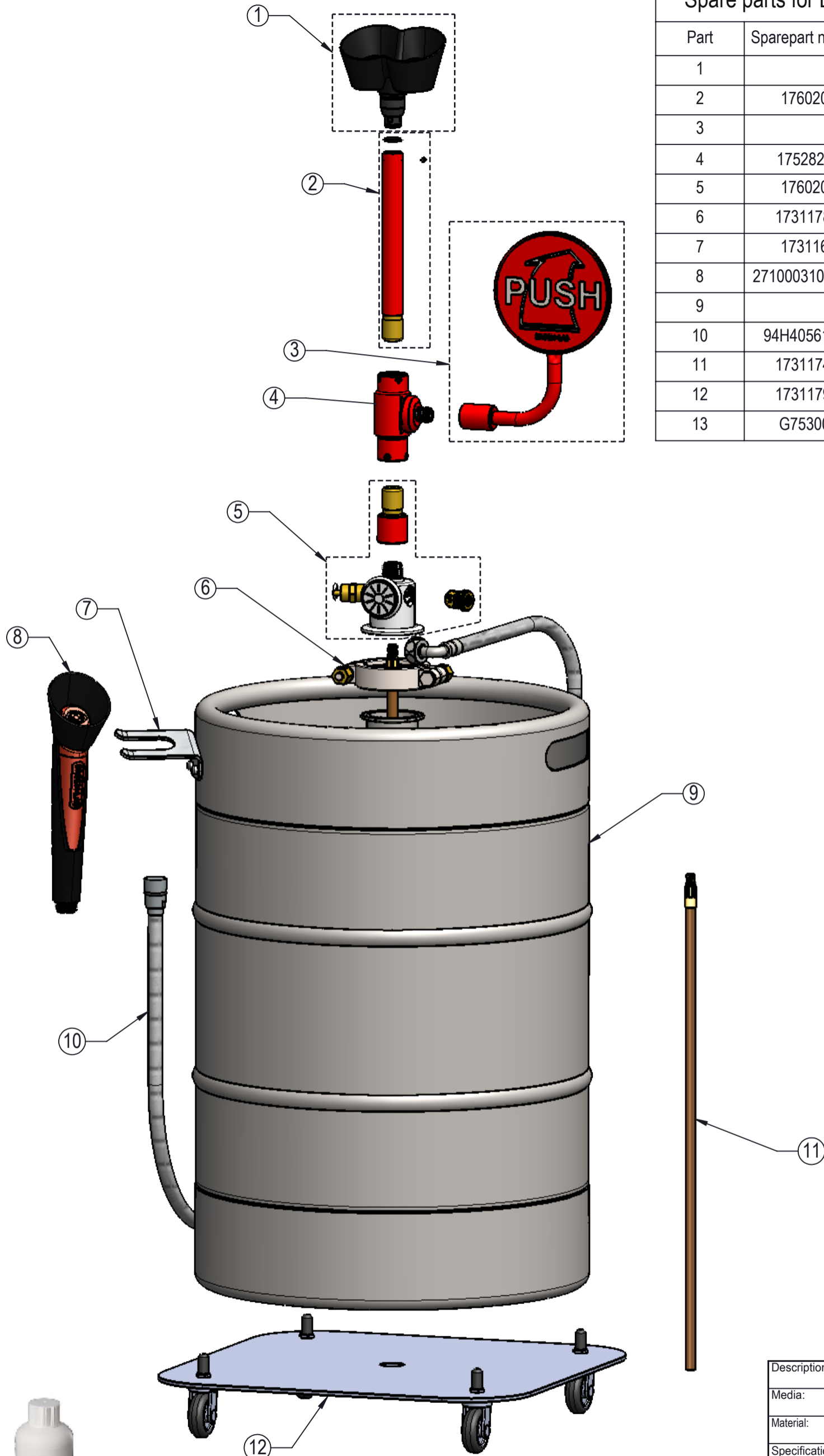

Description: Broen-Lab Portable Eyewasher	
Media: Water	
Material:	
Specification:	
Comments:	
Drawing type: Assembly drawing	Weight: 19.08 Kg
All dimensions marked with \varnothing are inspection dimensions	
Unspecified liniar tolerances:	
Unspecified angular tolerances:	
Designed by: MJO	Drawn by: MJO
Released on TM No.:	Date: 18-06-25
Format: A3	Drawing No.: 2737001100001SP

Rev.	Pos.	Date	TM No.	Design by	Drawn by	Change:

BROEN-LAB

This drawing is our property and cannot be given to a third party, copied or otherwise used without our permission. BROEN-LAB A/S

